



Photos: The Harbour Bridge and Opera House from Campbell's Cove, Patty Mazza

Sydney

A Welcoming City for People with Disabilities and Seniors, Accessible Accommodation



Easy Access Australia Publishing Pty Ltd

Disclaimer

Easy Access Australia Publishing Pty Ltd, The University of Technology Sydney and the City of Sydney make no representation about the content and suitability of this information for any purpose. It is provided "as is" and "as available" without any guarantees or warranty, expressed or implied as to the currency, accuracy, quality, completeness, availability or usefulness of data, information, product, or process provided through this service, and no responsibility or legal liability is assumed for any damages or inconvenience arising from its use.

In addition the City of Sydney website contains disclaimers:
<http://www.cityofsydney.nsw.gov.au/copyright/Disclaimer.asp>

Sydney, A Welcoming City for People with Disabilities and Seniors, Accessible Accommodation

Sydney Harbour YHA - The Rocks

110 Cumberland St
Sydney 2000

Sydney Harbour YHA is perched above The Rocks tourist and culinary precinct of Sydney and less than 5 minute stroll to Bridge Climb (access is available to the Visitors Centre and hearing loops are installed on the Bridge). The SH YHA is about 10 mins to the Rocks and its attractions including Circular Quay. The YHA building is an architectural wonder spanning an archaeological site so nearly all rooms face onto the central open space. Two access rooms offer views of the harbour!!

Number of Access Rooms:	5 rooms comprising; 2 doubles, 2 four bed dormitories and a 6 bed dormitory.
Star Rating:	Backpacker - Delux
Freecall:	Nil
Phone:	61 2 8272 0900
TTY Phone:	Nil
Web:	http://www.yha.com.au/
Email:	sydneyharbour@yha.com.au

Transport and parking

- Train, Ferry & Bus to Circular Quay, Taxi & Shuttle Bus to door.
- No on site parking. One dedicated public access space on Cumberland St opposite YHA.
- Parking arrangement with nearby commercial parking stations.
- Drop-off is on the street with no immediate crossovers – the nearest is approximately 20mtrs away.



Photo: Street view of the Sydney Harbour YHA.



Sydney, A Welcoming City for People with Disabilities and Seniors, Accessible Accommodation

Main entry and foyer

- Level from street through automatic opening doors.
- There is a short gentle grade prior to the lift.
- This door is secured at night. (Swipe slot/intercom to enter).
- Lift to Level 1 Reception.
- Reception desk height 1.2m.
- Flooring is non slip, environmentally friendly rubberized surface.



Photo: Courtesy YHA Ltd, Reception Foyer.



Photo: Courtesy YHA Ltd, Lounge.

Signage, Toilets, Telephones, Lifts and Corridors

Signage, Toilets, Telephones	Corridors
<p>Signage clear and highly visible for:</p> <ul style="list-style-type: none"> ○ EXIT • There are well signed accessible toilets provided. • There is no accessible telephone provided but the standard payphone is nearby at reception. 	<ul style="list-style-type: none"> • Corridor width 1.54m. • Flooring is Rubberized eco flooring throughout the hostel, carpet in the rooms. • Access rooms are located either adjacent to the lift or not far from it. • Hand rails are not installed. • No tactile way finding information. However Tactile warning tiles at the foot and top of the staircase. •

Sydney, A Welcoming City for People with Disabilities and Seniors, Accessible Accommodation

Lifts	
<ul style="list-style-type: none"> • Tactile lift call button is provided. • Call button height from floor surface is approx. 1m. • Audible lift arrival signal. • Internal Audio Floor Announcement. • Internal buttons in the range 1m – 1.2m, do have Braille or tactile components. 	

The Accessible Room No 119 – Four bed dormitory

Key Measurements: 4m x 4.4m

- Door width 860mm, the clear open width.
- Lever handle, 1m height from the floor.
- Swipe card entry to the room main door.
- Latch side space 900mm.
- Automatic door return.
- Internal corridor width 1.8m wide at it narrowest point.
- Bunk bed 475mm in height to the floor.
- Space to underside of upper bunk 830mm.
- Space underneath approx 20cm, no capacity to increase this space.
- Light switch 1.0m above the floor.
- Short grade between the carpeted and tiled areas.
- No Television.
- Lights can be operated from bed.

The Basin

- Basin height bottom front edge to floor 770mm.
- A Lever tap is provided.



Photo: Showing room entry, ample circulation space, basin outside bathroom.



Photo: Showing bunk bed and circulation space.

Sydney, A Welcoming City for People with Disabilities and Seniors, Accessible Accommodation

Room 237

Also a four bed dorm. The bathroom measures 2.6m x 2.34m. The room offers glimpses of the harbour.

The Bathroom Room No. 119

Key measurement 2.45m x 2.2m

- Bathroom door opens inward, hinged on the left. Clear width 860mm.
- Lever handle 1m.
- Light switches at 1m.

The Toilet

- Height (top of pan) 450mm.
- Front of bowl to back wall 800mm.
- Space from centerline of bowl and side wall is 490mm.
- Toilet Grab rails height 800mm.



Photo: Toilet, grab rails and shower.

The Shower

- Wheel-in-shower with no hob.
- A fold down shower seat is provided: 470mm high, 400mm wide & 1m long
- A Hand-held shower rose is provided.
- Grab rails are 800mm.
- Lever tap 1m above the floor.



Photo: Shower area with plastic strip on the floor and fold down shower seat.

Sydney, A Welcoming City for People with Disabilities and Seniors, Accessible Accommodation

Floorplan Accessible Room 119

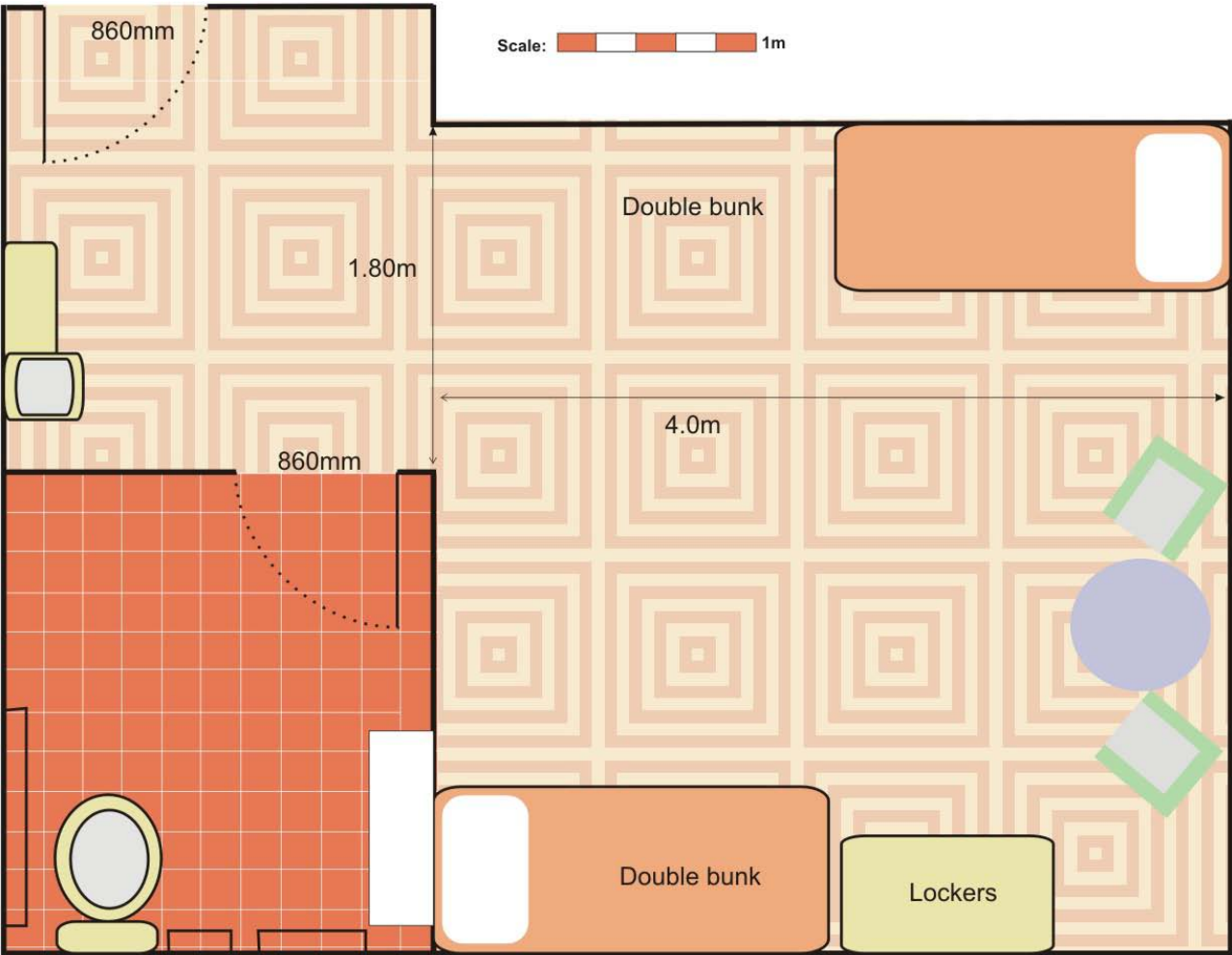

Sydney, A Welcoming City for People with Disabilities and Seniors, Accessible Accommodation

The Accessible Room No 114 – Double room

Key Measurements: 3m x 3.6m

- Short grade up to the door from outside.
- Door width 860mm, the clear open width.
- Lever handle, 1m height from the floor.
- Swipe card entry to the room main door.
- Latch side space less than 400 mm.
- Automatic door return.
- Internal corridor width 1.48m wide at it narrowest point.
- Double bed 475mm in height to the floor.
- Space to underside of upper bunk 830mm.
- Space underneath approx 20cm, no capacity to increase this space.
- Light switch 1.0m above the floor.
- No Television.
- Lights can be operated from bed.
- Tea/coffee making facilities reached across the desk.
- Desk height underneath 715mm.

Room 235

(Not sighted) Also a Double room with no bunk over the bed but with roll out trundle bed. The bed height is 600mm with ample space underneath for a hoist. This room offers harbour views including the Opera House.



Photo: Showing room entry, bathroom entry from the corridor and grade up from the room area.



Photo: Showing room circulation space and desk.



Photo: Showing bunk bed and circulation space.

Sydney, A Welcoming City for People with Disabilities and Seniors, Accessible Accommodation

The Bathroom Room No 114

Key measurement 2.0m x 2.6m

- Bathroom door opens inward, hinged on the right. Clear width 860mm.
- Lever handle 1m.
- Light switches at 1m.

The Basin

- Basin height bottom front edge to floor 770mm.
- A Lever tap is provided.

The Toilet

- Height (top of pan) 450mm.
- Front of bowl to back wall 800mm.
- Space from centerline of bowl and side wall is 460mm.
- Toilet Grab rails height 800mm.

The Shower

- Wheel-in-shower with no hob.
- A fold down shower seat is provided: 470mm high, 400mm wide & 1m long
- A Hand-held shower rose is provided.
- Grab rails are 800mm.
- Lever tap 1m above the floor.



Photo: Toilet, grab rails and shower.

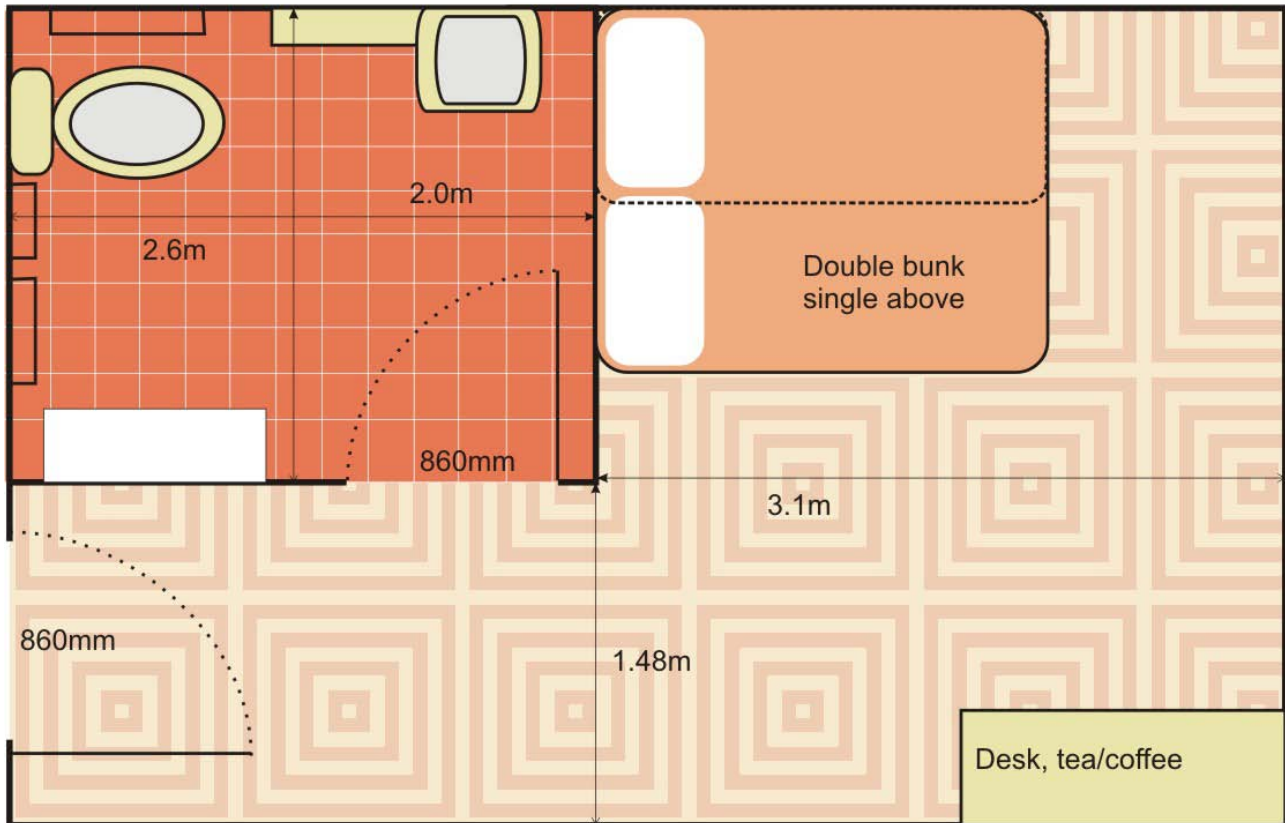

Photo: Shower with fold down shower seat.

Sydney, A Welcoming City for People with Disabilities and Seniors, Accessible Accommodation

Floorplan Accessible Room 114

Scale:  1m



Respiratory and Other Sensitivity

- Management pursues a smoke, chemical and toxin-free environment. EcoLab cleaning products are used throughout the hostel.
- Natural ventilation is a key feature of the building's architecture. Most rooms open onto a central open space.
- The hotel has minimal use of chemical pesticides, herbicides and toxic pest controls.
- Please contact management in respect to specific information on its policy covering assistance animals. Guests with guide dogs are welcomed.



Photo: Building designed around natural ventilation. Note the archaeological dig.

Sydney, A Welcoming City for People with Disabilities and Seniors, Accessible Accommodation

Other Facilities

Restaurants & Bar	Emergency
<ul style="list-style-type: none"> ▪ No restaurant within the hostel, however there is a café as part of Reception and the kitchen is open plan – but no knee space under the sink. The hostel is close to two pubs and restaurants in The Rocks. 	<ul style="list-style-type: none"> ▪ There is a documented Emergency procedure. ▪ The Emergency warning system comprises Audio and visual alarms. ▪ The Emergency alarms are located in all rooms and public places.
Swimming Pool - NA	
Other Services	
<ul style="list-style-type: none"> ▪ Management fosters a “can do attitude” amongst staff and welcomes guests with disabilities. ▪ Assistance hiring equipment is available. ▪ While there is no swimming pool, the roof top is accessed via lift providing stunning views across the harbour to the Opera House and Bridge. 	 <p style="text-align: center;"><i>Photo: Courtesy YHA Ltd, view of the roof top deck, Harbour Bridge and Opera House.</i></p>